

**IMPORTANT, RETAIN FOR FUTURE REFERENCE:
READ CAREFULLY!**

INSTRUCTION MANUAL FOR USE OF PLAYPEN AND CRIB „SAHARA”

SAHARA

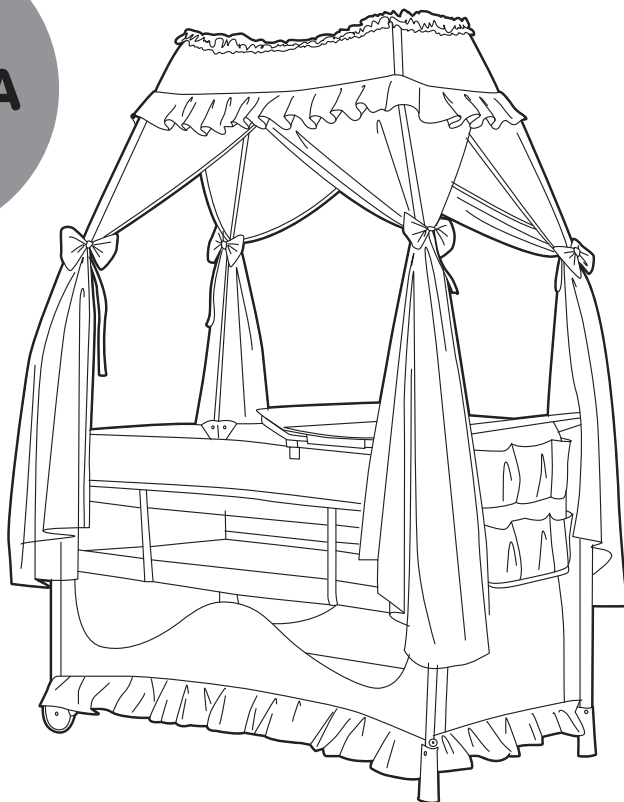

This playpen **chipolino** has been designed and manufactured in accordance with the Product Safety Directive 2001/95/EU of the European Parliament and the Council and to European standard EN 716 Children's cots and folding cots for domestic use, Part 1 Safety requirements and EN 12221 Child use and care articles. Changing units for domestic use. Part 1 Safety requirements as well as the regulations of national legislation including the consumer protection law.

ATTENTION! YOUR CHILD WILL BE MOST SECURE IF YOU FOLLOW THE INSTRUCTIONS AND RECOMMENDATIONS GIVEN IN THIS USER'S MANUAL!

WARNING!

- **WARNING!** NEVER LEAVE THE CHILD UNATTENDED!
- **WARNING!** BE AWARE OF THE RISK OF OPEN FIRE AND OTHER SOURCES OF STRONG HEAT, SUCH AS ELECTRIC BAR FIRES, GAS FIRES, ETC. IN THE NEAR VICINITY OF THE COT!
- **WARNING!** DO NOT USE THE COT IF ANY PART IS BROKEN, TORN OR MISSING AND USE ONLY SPARE PARTS APPROVED BY THE MANUFACTURER.
- The producer does not take any responsibility for the safety of the child when you have not used the proper and original spare parts, approved and provided by him!
- **WARNING!** DO NOT LEAVE ANYTHING IN THE COT OR PLACE THE COT CLOSE TO ANOTHER PRODUCT, WHICH COULD PROVIDE A FOOTHOLD OR PRESENT A DANGER OF SUFFOCATION OR STRANGULATION, E.G. STRINGS, BLIND/CURTAIN CORDS, ETC.!
- **WARNING!** DO NOT USE MORE THAN ONE MATTRESS IN THE PLAYPEN! FOLLOW EXACTLY THE MARKINGS ON THE INNER SIDE OF THE PLAYPEN DESIGNATING THE MAXIMUM ALLOWED HEIGHT OF THE MATTRESS TOP!
- **WARNING!** The thickness of the mattress should be so that the inner height (from top of the mattress up to edge of the playpen rail) is less than 500 mm (see the markings on the playpen).
- **WARNING!** Minimum size of length and width of used mattress in playpen must be so that the inner space between mattress and all sides of the play pen to be less than 30 mm!
- The playpen and changing mat must be used for one child at a time!
- The playpen must NOT be used for by a child who can climb and hand on it, because he/she can tip it over, fall down and get hurt!
- **ALWAYS** before use the playpen make sure that locking mechanisms are fully engaged. Only then the playpen is safe for usage!
- Use the second level of playpen only for children who **CANNOT** sit unaided and **CANNOT** roll or pushup with hands and knees!
- Bottom level of playpen is safest for your child. Use it for children who can sit unaided!
- In case you leave your child in playpen with no supervision, make sure that all rails are locked!
- Do **NOT** use the hanging mosquito net if your child can sit unaided and roll or pushup with hands and knees!
- All fasteners must be always well tightened. They must be regularly reviewed and tighten if needed.
- Playpen to be used for a child weighting not more than 15 kg.
- Changing mat to be used for a child aged up to 12 months and weighting up to 11 kg.
- Assembly, folding and unfolding of the playpen to be made only by adult!
- Place the playpen only on horizontal and flat surface!
- Always apply the parking device of playpen! **USE THE WHEELS ONLY FOR MOVING THE PLAYPEN!**
- Do not allow children younger than 3 years near the stroller during the assembly or disassembly, in order to prevent the risk of injury or swallowing of small parts!
- The packaging of the product must be kept out of the reach of children to avoid the risk of strangulation!

MAIN FEATURES

- Playpen is suitable for newborn babies and children aged less than 15 kg.
 - Second level of playpen– suitable for younger babies
 - Changing mat – suitable for children aged less than 12 months and weighting less than 11 kg.
- ATTENTION!** Changing table is safe for usage only when it is installed on this model of playpen and it is not suitable to be used as a separate product!

- Two wheels with parking device
- Big pocket for toys
- Entrance with zipper
- Hanging mosquito net
- Compact folding
- Carry bag

MAIN PARTS

Please, make sure all described parts below are available:

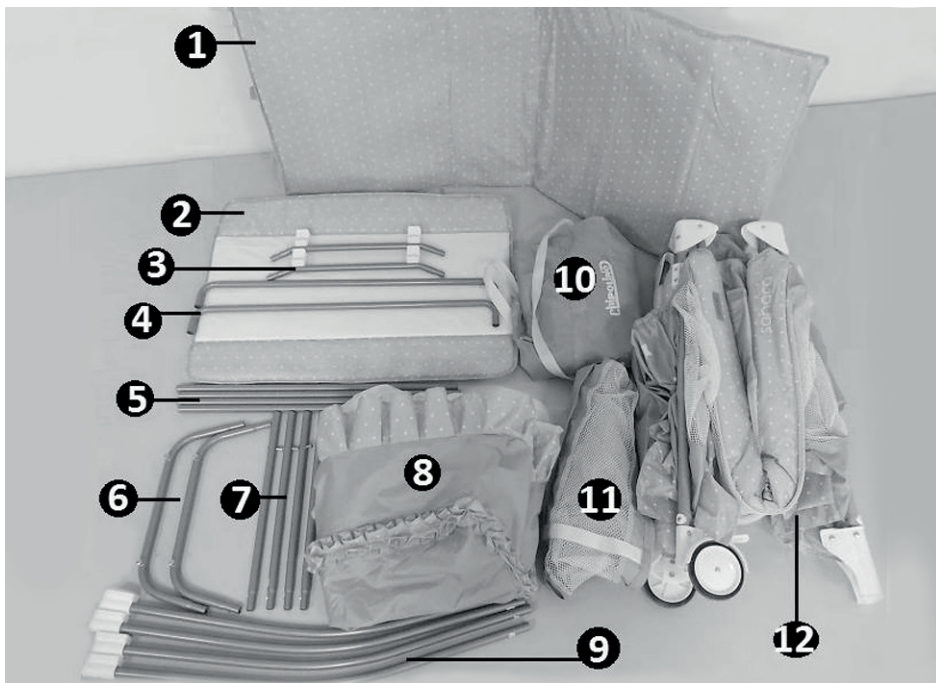

- | | |
|---|--|
| 1 Pad for the base of playpen | 7 Short tubes for the hanging mosquito net (4 pcs) |
| 2 Changing mat | 8 Long tubes for the hanging mosquito net (4 pcs) |
| 3 Short tubes for changing mat (2 pcs) | 9 Hanging mosquito net |
| 4 Long tubes for changing mat (2 pcs) | 10 Carry bag |
| 5 Tubes for second level of playpen (4 pcs) | 11 Second level of playpen |
| 6 P-shaped tubes for the hanging mosquito net (2 pcs) | 12 Playpen |

ASSEMBLY INSTRUCTION AND FUNCTIONS

This playpen is supplied partially assembled. In order to complete the assembly, you don't need any tools.

ATTENTION! Follow exactly the instructions given and check the pictures/figures.

ATTENTION! After each operation, make sure that you have followed the instructions correctly and the fixing is stable.

ATTENTION! Properly fixing is often accompanied with click sound.

ATTENTION! Be careful to avoid finger entrapment during each operation!

Assembly and functions are given in figures 1-7. Use all descriptions below together with figures with the same number.

2 – FIRST LEVEL OF PLAYPEN

3 – SECOND LEVEL OF PLAYPEN

4 – CHANGING MAT

5 – HANGING MOSQUITO NET

6 – WHEELS AND PARKING DEVICES

7 – FOLDING AND PACKING

Note: Before folding the playpen you must remove the hanging mosquito net, changing mat, pad of playpen, second level and all other additional accessories.

ATTENTION! Do not push stronger the rails if they don't fold from first time, because you may damage the mechanisms inside! Try again to follow all described actions.

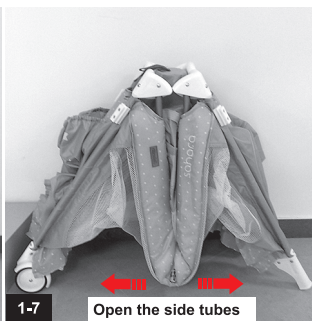
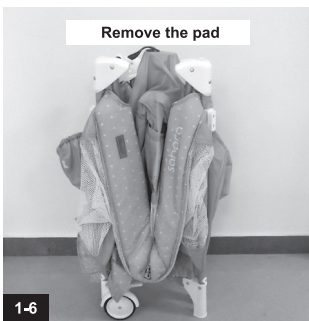

Remove the pad

Open the side tubes

Catch the long sides and pull upwards until they fix

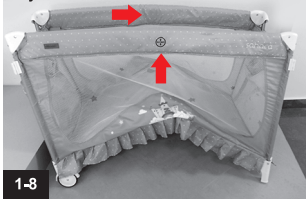

Catch the short sides and pull upwards until they fix

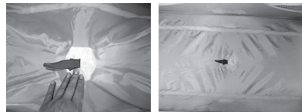
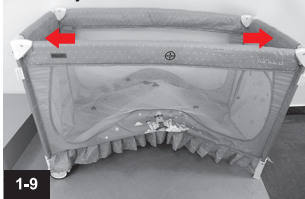

Press down the bottom center of the play pen

Place the pad



Insert the velcro straps through the holes and fasten them under the playpen

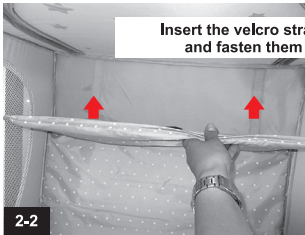

Attach the second level with the zipper



Close the zipper all playpen long



Cover the zipper mechanism with the fabric cover and fasten the velcro strap



Lock the buckle



Insert both sets tubes to the mattress holes and join them



Connect the free endings.

Place the pad on the second level. Insert the velcro straps through the openings of the second level and fasten them to underside.





4-1

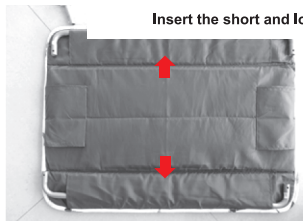

4-2

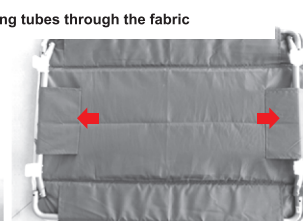

4-3

Insert the short and long tubes through the fabric

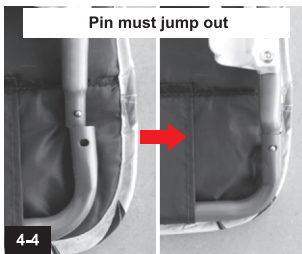

4-4

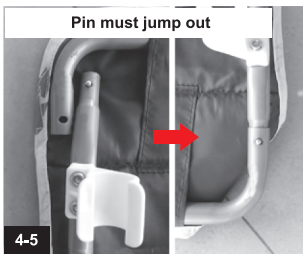

4-5



4-6

Pin must jump out

Pin must jump out

Correctly assembled changing mat



4-7



4-8



4-9



5-1

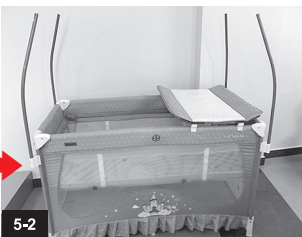

5-2



5-3



5-4



5-5

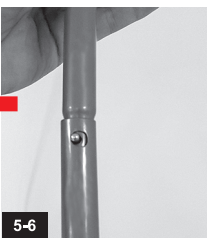

5-6



5-7

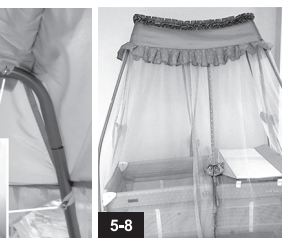

5-8

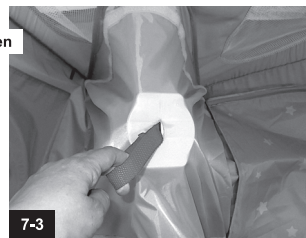
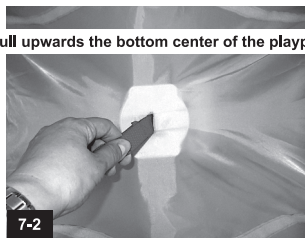
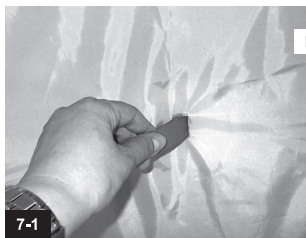

Pull upwards the bottom center of the playpen

Release the mechanisms on each rail of the playpen under the fabric. Fold all sides of the playpen together. Wrap with the mattress



Pack with the carry bag.



CARE AND MAINTENANCE

- Do not push the rails mechanism strongly to avoid damages.
- Clean the fabrics, plastic parts and metal parts with damp cotton cloth or sponge and mild soap.
- Do not use abrasive, bleach or other aggressive detergents.
- Always after cleaning leave the playpen, pad of playpen, changing mat, hanging mosquito net fully dry and after that use them or store them. It may appear mold if you keep them moist.
- Always store your product indoors. Do not expose to direct environment influence - sun, rain, moisture and high temperature intervals.
- Please, contact your authorized dealer for problems connected with the use or repair of this product.

Fabric content:

Shell: 100% polyester

Filling: 100% polyester



Used materials: textile, plastic, metal.

KOSISAx

chipolino

Bulgaria, Plovdiv, str. Golyamokonarsko shosse 1
www.chipolino.com