

**IMPORTANT! READ CAREFULLY AND KEEP FOR FUTURE REFERENCE!**

## **INSTRUCTION FOR USE OF CO-SLEEPING BASSINET WITH DROP SIDE „SWEET DREAMS”**



This product **chipolino** has been manufactured in accordance with the Product Safety Directive 2001/95/EU of the European Parliament and The Council and with European standard EN 1130: 2019 „Children’s furniture. Cribs. Safety requirements and test methods.”, and the regulations of national law, including Consumer Protection Law.

**FOLLOW ALL WARNINGS, INSTRUCTIONS AND RECCOMENDATIONS IN  
THIS MANUAL IN ORDER TO GUARANTEE THE SAFE USE OF THIS PRODUCT**



**CAUTION! WARNINGS!**

- **WARNING!** DO NOT USE THIS PRODUCT WITHOUT READING THE INSTRUCTIONS FOR USE FIRST!
- **WARNING!** NEVER LEAVE CHILD UNATTENDED!
- **WARNING!** STOP USING THE PRODUCT AS SOON AS THE CHILD CAN SIT OR KNEEL OR PULL ITSELF UP!
- **WARNING!** PLACING ADDITIONAL ITEMS (SUCH AS TOYS, PILLOWS, ETC.) IN THE PRODUCT MAY CAUSE SUFFOCATION!
- **WARNING!** DO NOT PLACE THE PRODUCT CLOSE TO ANOTHER PRODUCT, WHICH COULD PRESENT A DANGER OF SUFFOCATION OR STRANGULATION, E.G. STRINGS, BLIND/CURTAIN CORDS, ETC.!
- **WARNING!** IN ORDER TO AVOID THE RISK OF CHILD'S NECK ENTRAPMENT IN THE TOP RAIL OF BASSINET'S DROP SIDE, LOCATED NEXT TO ADULT'S BED, THE TOP RAIL SHOULD NOT BE HIGHER THAN ADULT'S BED MATTRESS!
- **WARNING!** IN ORDER TO AVOID THE RISK OF CHILD'S ENTANGLEMENT, THE BELTS WHICH FIX THE PRODUCT NEXT TO THE ADULT'S BED MUST BE KEPT OUT OF REACH AND OUT OF THE PRODUCT.
- **WARNING!** IN ORDER TO AVOID THE RISK OF CHILD FALLING OUT OF THE PRODUCT, IT SHOULD BE USED ONLY IF IT IS WELL FIXED TO ADULT'S BED OR IF THE DROP SIDE IS FIXED IN ITS HIGER POSITION.
- **WARNING!** DO NOT USE MORE THAN ONE MATTRESS IN THE PRODUCT.
- **WARNING!** DO NOT PLACE MATTRESS THICKER THAN 30 mm IN THE PRODUCT.
- **DANGER!** ALWAYS KEEP THE DROP SIDE FIXED IN ITS HIGHER POSITIN WHEN PRODUCT IS NOT FIXED NEXT TO ADULT'S BED!
- The product should be placed only on a horizontal floor! Uneven surfaces may cause the product to be unstable!
- Young children should not be allowed to play unsupervised in the vicinity of the product!
- Before each use make sure that all fixings are locked.
- **DO NOT** use crib if any parts are missing, damaged, or broken. Contact manufacturer or an authorized dealer for replacement parts and instructional literature if needed.
- **DO NOT** substitute parts! The manufacturer shall not be responsible for the safety of the product in case substitute parts were used which were not approved and/or provided by the manufacturer!
- All assembly fittings should always be tightened properly and that care should be taken that no screws are loose, because a child could trap parts of the body or clothing (e.g. strings, necklaces, ribbons for babies' dummies, etc.), which would pose a risk of strangulation.
- Be aware of the risk of burning cigarettes, open fires and other sources of strong heat, such as electric bar fires, gas fires, etc. in the near vicinity of the product.
- **DO NOT** use the body of the product without its frame.
- The product shall never be used in an inclined position.
- When using the function "Co-sleep mode (fixed to adult's bed)" in order to prevent the risk of suffocation hazard due to entrapment, the product shall be securely fixed to the adult's bed using the attachment system.
- Use only the belts for fixing the crib next to adult's bed which are provided with this product!  
**DO NOT** use any other belts or system for fixing!
- The crib must be tight against the adult's bed and no gap is allowed between crib and the adult's bed mattress. **DO NOT** use the product if you find there is a gap! Do not fill the gap with pillows, blankets or other objects.
- Check if the crib is securely fixed to adult's bed by trying to pull it away from the bed.
- The product must **NOT** be used for more than one child at a time!
- Assembly, folding and unfolding of the product to be done by adults **ONLY!**
- **DO NOT** allow children younger than 3 years old near the product during the assembly or disassembly in order to prevent the risk of injury or swallowing of small parts!
- The plastic bags must be kept away from children to avoid the risk of suffocation!

## MAIN FEATURES

- The product is intended for children aged 0 to 6 months weighing no more than 9 kg;
- “Co-sleep mode (fixing to the adult’s bed)”, that allows the parent to safely sleep close to the child;
- Easily removable upholstery, easy for cleaning;
- Height adjustable cot;
- Storage space.

## MAIN PARTS

Please, make sure if all parts are available:

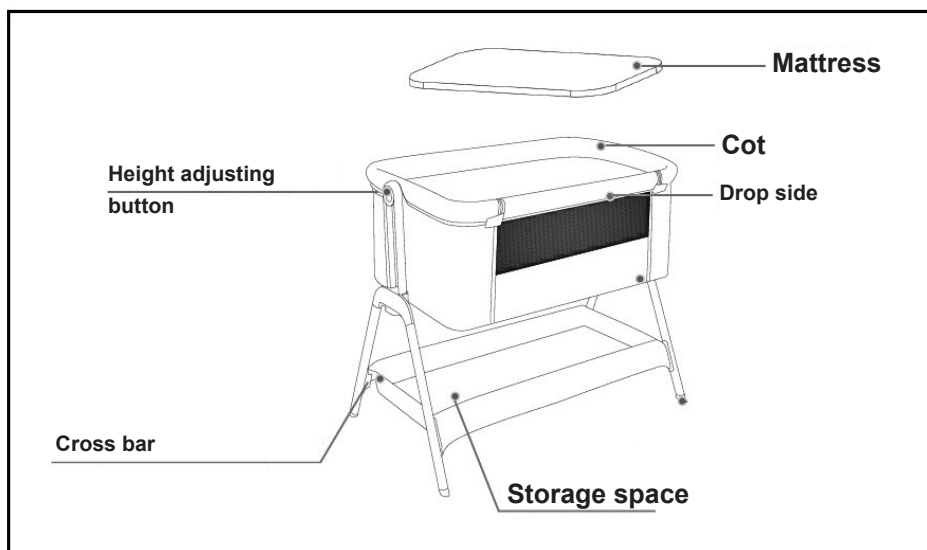

## INSTRUCTIONS FOR ASSEMBLY AND FUNCTIONS

**CAUTION!** Follow exactly the instructions given and check the pictures.

**CAUTION!** AFTER EACH OPERATION, MAKE SURE THAT EACH FIXING IS SECURE!

**CAUTION!** In most cases after the completion of an operation you will hear a clicking sound.

**CAUTION!** Keep away your fingers from pinching during assembly!

No tools are needed to complete the assembly of this product.

The assembly and functions are numbered from 1 to 6. Use the operations descriptions given in this manual and their matching picture

## ASSEMBLY

### 1 – INSTALLING OF THE CROSS BAR AND SIDE SUPPORTS

### 2 – INSTALLING THE COT

2-1 – Fix the cot to the side supports and fasten the Velcro strap; 2-2 – Fasten all zippers;

2-3 – Place the mattress on the bottom of the cot;

2-4 – Installed cot.

## FUNCTIONS

### 3 – HEIGHT ADJUSTMENT

3-1 – Adjusting the cot in higher position – pull the two height adjusting buttons simultaneously and move the cot in higher position.

3-2 – Adjusting the cot in lower position – pull the two height adjusting buttons simultaneously and move the cot in lower position.

### 4 – DROP SIDE

4-1 – Open the zippers on both sides;

4-2 – **Note:** Press in the direction of marked arrow;

4-4 – Roll the fabric around the drop side top rail and fix it.

### 5 - „FIXING TO ADULT'S BED”

Thread the belts under and over bed's mattress, buckle them and tighten.

**ATTENTION!** MAKE SURE THAT THE SUPPORT TUBES ARE TIGHTLY PRESSED AGAINST THE ADULT'S BED SIDE!

### 6 – MOSQUITO NET (sold separately)

**Note:** The mosquito net is sold separately and can be purchased.

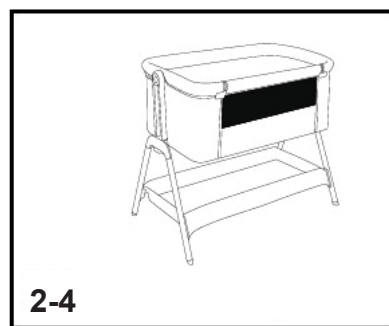
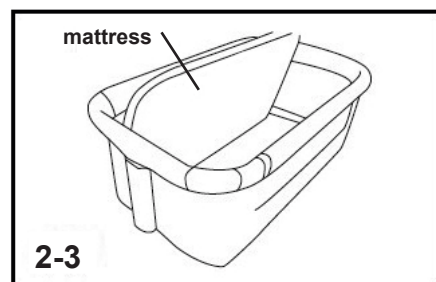
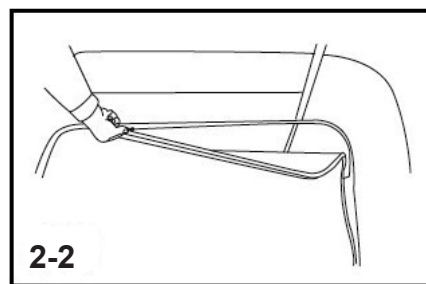
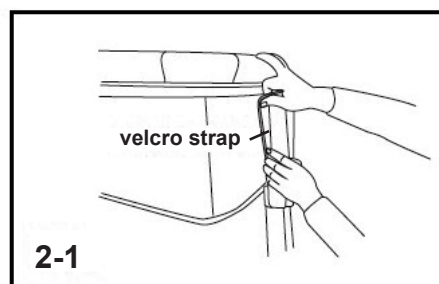
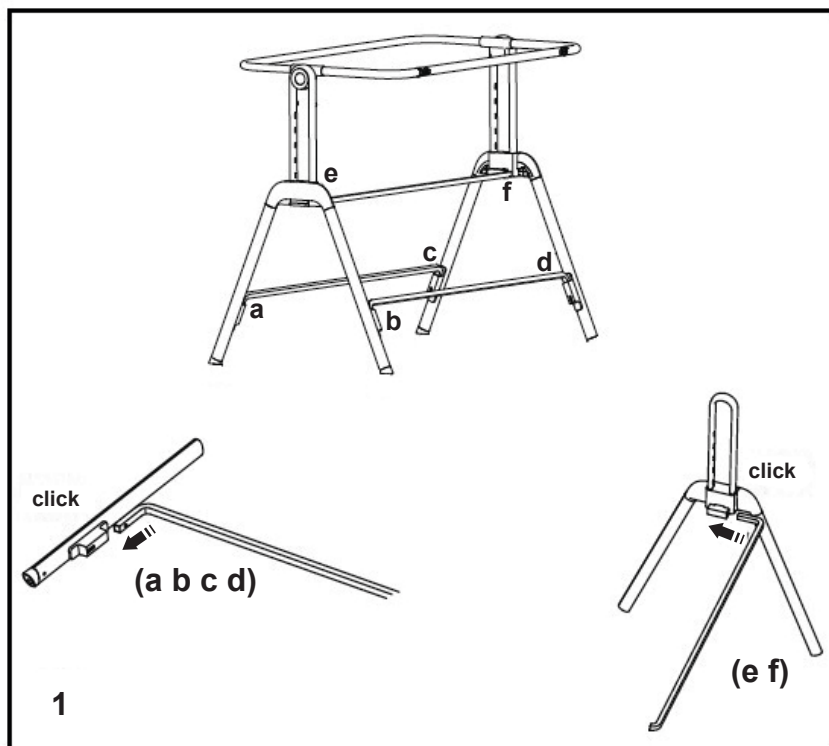

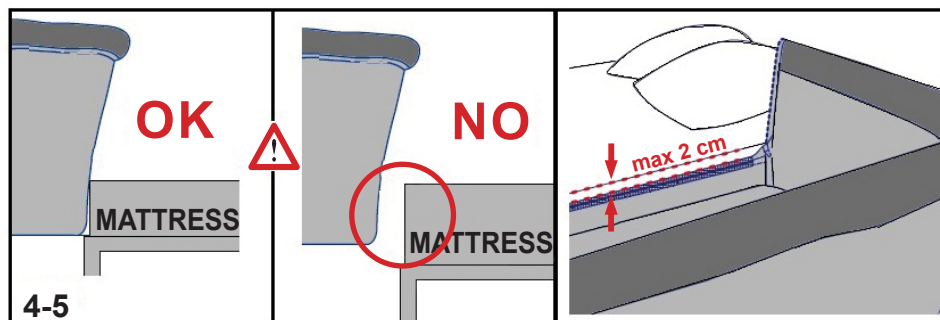
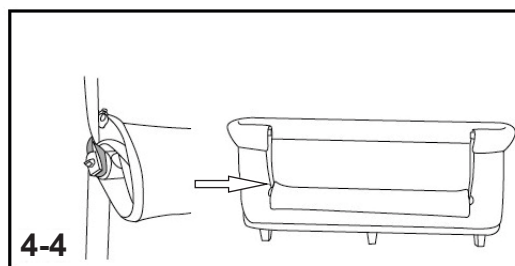
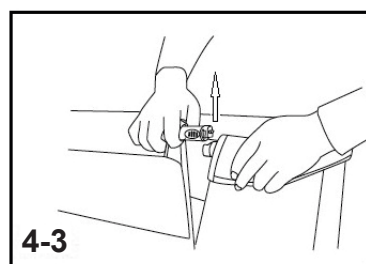
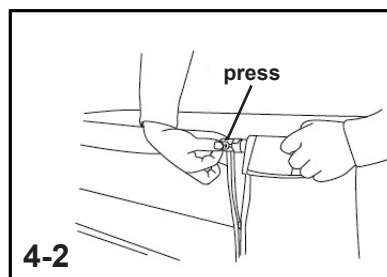
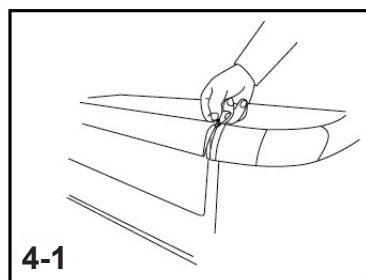
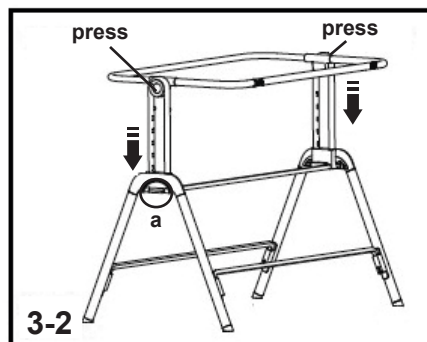
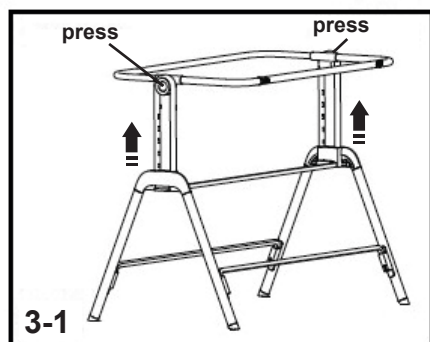

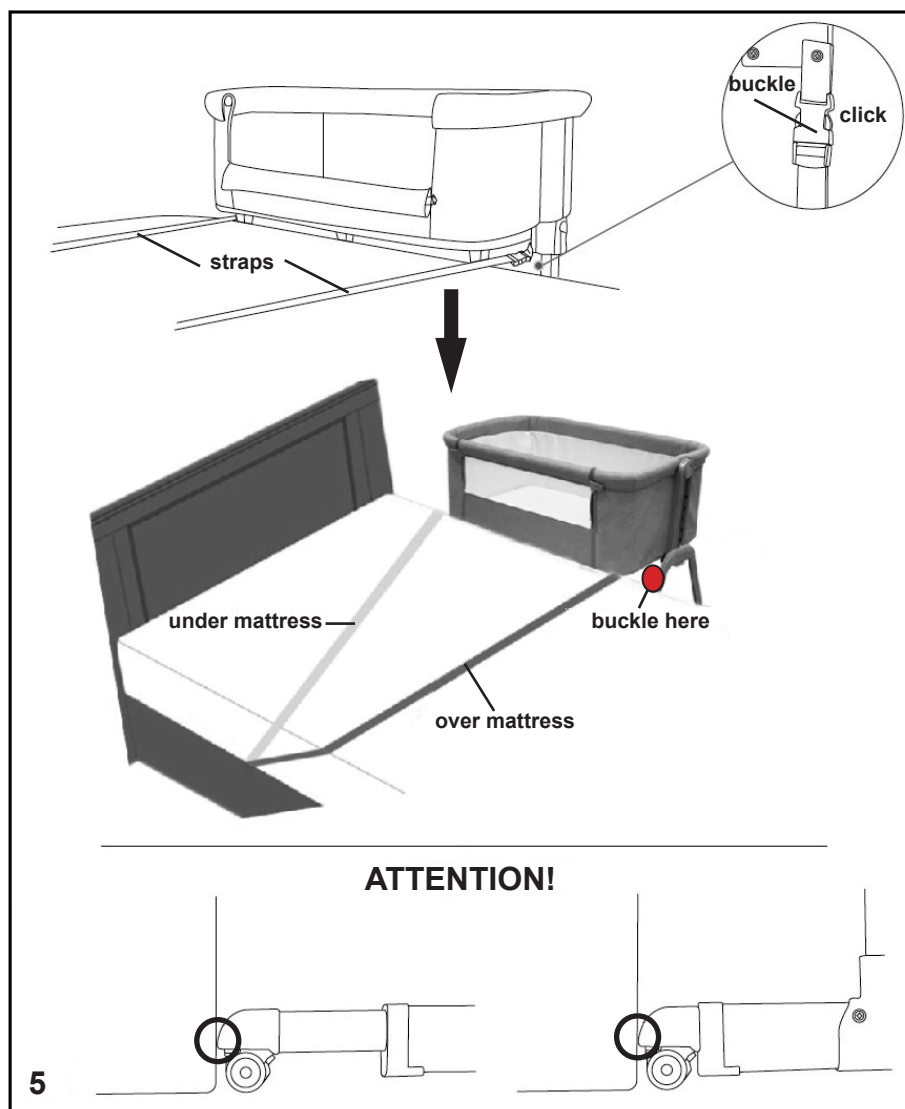

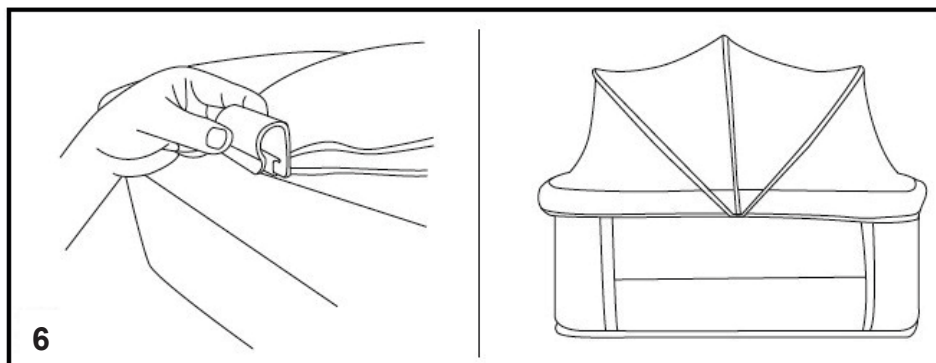

## CARE AND MAINTENANCE GUIDELINES

- Do not apply strong pressure on the mechanisms for adjusting and folding, as this may damage or brake them.
- Clean the plastic and metal parts with wet soft cotton cloth or sponge and mild detergent.
- The fabric parts may be hand washed 300 C. Follow the instruction from the washing label.
- Do not tumble dry or use drying machine!
- Do not use aggressive detergents containing abrasive particles, ammonia, bleach or alcohol.
- Always air dry the crib and mattress before storing them to avoid the forming of mold.
- Store the product in a clean and dry place. Do not expose it to direct environment influence - sunlight, rain, moisture or drastic temperature changes!
- Do not place objects or other products on top of the products as this may damage its construction or upholstery.
- In case of any problems connected with the normal use of the crib, consult the manufacturer or authorized dealer.

**Materials used:** plastic, textile, metal.

**KOSSDO20xxx**





---

1 Goliarnokonarsko shosse, Plovdiv, BULGARIA  
[www.chipolino.com](http://www.chipolino.com)