

**IMPORTANT! KEEP THIS MANUAL FOR REFERENCE  
DURING THE WHOLE TIME OF USE!**

**INSTRUCTION MANUAL  
FOR USE OF CAR SEAT  
“ESTELLE”**

**ESTELLE**

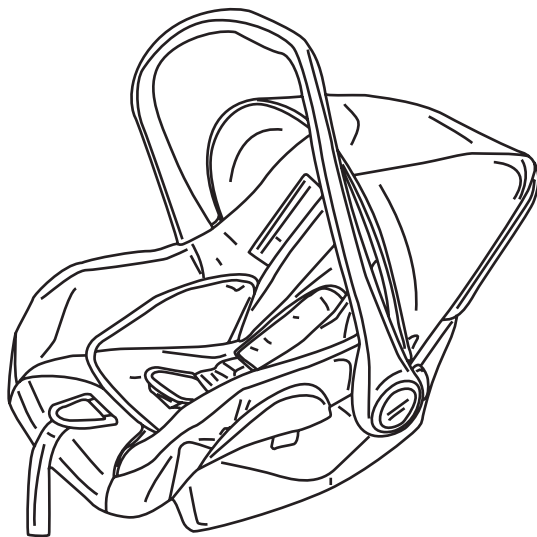

This child restraint **chipolino** is designed and manufactured in compliance with the requirements of Regulation 44 of the United Nations Economic Commission for Europe concerning the safe transportation of children, the provisions of the product safety directive 2001/95/EU of the European Parliament and The Council and Directive 91/671/EEC “Compulsory use of seat belts and child restraints systems for child occupants of power driven vehicles” of the European Parliament and The Council, as well as the Consumer Protection law and the national legislation.

**Б Е Л Е Ж К А**  
**за полууниверсална система за обезопасяване на деца теловна група 0+ (0-13kg)**

Тази система за обезопасяване на деца е класифицирана като „Полууниверсална“ и е подходяща за закрепване към седалките на следните леки автомобили:

<u>ЛЕК АВТОМОБИЛ</u>	<u>ОТПРЕД</u> <u>Отвън</u>	<u>ОТЗАД</u> <u>В средата</u>
Всички гледащи напред седалки с 3-точков обезопасителен колан за възрастни	Да	Не

За поставяне на тази система за обезопасяване на деца може да са подходящи местата за сядане и в други леки автомобили. Ако имате съмнения, консултирайте се с производителя на системата за обезопасяване или търговеца на дребно.

**NOTECE**

This child restraint is classified Semi-universal use and is suitable for fixing into the seat positions of the following car:

<u>CAR</u>	<u>FRONT</u> <u>Outer</u>	<u>REAR</u> <u>Centre</u>
All front facing set with three point adult belt	Yes	No

Seat positions in other cars may also be suitable to accept this child restraint. If in doubt, consult either the child restraint manufacturer or the retailer.



**NO RESTRAINT SYSTEM CAN PROVIDE ABSOLUTE PROTECTION IN  
CASE OF A CRASH OR ROAD ACCIDENT  
DRIVE WITH CARE WHEN THERE IS A CHILD IN YOUR VEHICLE!**

**IN ORDER TO ENSURE THE SAFETY OF YOUR CHILD FOLLOW EXACTLY  
THE INSTRUCTIONS AND SAFETY RECOMMENDATIONS IN THIS MANUAL!**

## PLACE OF THE CAR SEAT IN THE VEHICLE

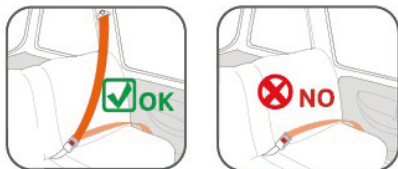

This restraint system is suitable for use only in vehicles with approved lap/3-point/static/retractable safety belts approved to Regulation ECE R16 of UN ECE!

**Group 0+ (0-13 kg)**



Never install the car seat on passenger seat equipped with airbag which cannot be deactivated! This could lead to serious injury or death!



Child car seat must be installed in car only in direction opposite to motion, so child is "rearwards facing"!

## CAR BELTS SUITABLE FOR CHILD CAR SEAT INSTALLATION IN VEHICLE

Type	RETRACTING DEVICE						Without retracting device
	Diagonal belt Plus ELR	Lap belt Plus ELR	Diagonal belt Plus ALR	Lap belt Plus ALR	Automatic	Non-locking retractor	
2-point	-	X	-	X	X	X	X
3-point	O	X	O	X	X	O	O

**O** – suitable

**X** – not suitable

**ELR** - Emergency locking retractor

**ALR** - Atomically locking retractor

**NLR** - Non-locking retractor

Type of car belt	Features	Installation of child car seat
<b>3 – point safety belt type Plus ELR</b> (Emergency locking retractor)	During normal usage belt can be pulled freely; In case of an accident, belt locks automatically.	Thread the diagonal belt into the fixing part of the child car seat basis to fix the child car seat to seat of the car.
<b>2 – point safety belt Plus ALR</b> (Atomically locking retractor)	Retractor that will automatically lock by stop during pulling the safety belt.	Child car set cannot be installed.
<b>3- point safety belt Plus ALR / ELR</b> (Retractor for child car seat)	3- point safety belt Plus ELR setting + function ALR for child car seat fixing in car.	Switch to function ALR after you fix the child car seat and pull safety belt. Function ALR is forbidden in children mode.
<b>3- point safety belt Plus ALR</b> (Atomically locking retractor)	Retractor that will automatically lock by stop during pulling the safety belt.	Pull the needed length for child car seat installation and after that install the child car seat of seat of car.
<b>3- point safety belt Plus NLR</b> (Non-locking retractor)	Without lock; Pull the belt as long as possible and adjust according to child's height.	Pull the safety belt from retractor and adjust it according to child's height.
<b>Manual 3-point safety belt</b>	No retractor; Adjust according to child's height.	Adjust the length of the safety belt according to child car seat and after than install the child car seat.

- ❖ NEVER LEAVE THE CHILD IN THE CAR SEAT UNATTENDED!
- ❖ DO NOT INSTALL THE CAR SEAT IN A WAY DIFFERENT FROM THE ONE SHOWN IN THE INSTRUCTION. IT IS DANGEROUS TO USE BEARING CONTACT POINTS OTHER THAN THOSE DESCRIBED IN THIS MANUAL AND MARKED ON THE CAR SEAT!
- ❖ IT IS VERY IMPORTANT THAT THE LAP BELT IS LAYING LOW AND THE CHILD'S HIPS ARE SNUG!
- ❖ DO NOT MAKE CHANGES, ADDITIONS OR MODIFICATIONS ON THE CAR STRUCTURE WITHOUT THE APPROVAL OF THE NOTIFIED BODY! If necessary, contact the supplier or an authorized service center for advice or repair.
- ❖ IMPROPER USE OF THE CAR SEAT WILL CONTRIBUTE TO REDUCING ITS SAFETY AND SECURITY CAPABILITY! Failure to comply with the directions for use in this manual increases the risk of serious injury or death!
- ❖ KEEP AWAY FROM FIRE!
- ❖ Use this car seat for newborn babies and children up to 13 kg.
- ❖ This car seat must be installed and handled only by adult!
- ❖ Hard parts and the parts of the restraint system, made of plastic, must be located and installed so that when the vehicle is in normal operation, they cannot be trapped by a sliding seat or in vehicle door.
- ❖ The three-point belt for adults, which attaches the child seat to the vehicle seat, must be well stretched, not pinched by the door, wrapped on the seat or any other part of the vehicle. It should not rub against sharp edges or parts.
- ❖ The belts of the car seat should not be twisted, they should be properly fastened and adjusted to the child's body.
- ❖ The belts - of the car seat and the vehicle - should not be twisted, frayed or torn, latches and locks (buckles) must be in order. Make sure that they are firmly fixed.
- ❖ If you find uncertainty or failure in the structure, latches, straps or locking mechanisms, discontinue usage until removal of the damaged parts and replacement with new ones.
- ❖ If the car seat has been subject to destructive loads during violent impact or accident, replace it with new.
- ❖ Never use a second-hand car seat or second-hand spare parts! The car seat may have been in a violent impact or car crash.
- ❖ Do not use this car seat without its seat cover and do not replace it with a new one, unless supplied by the manufacturer.
- ❖ Do not use the car seat if the child's head is above the upper edge of the car seat!
- ❖ Any luggage or other items that are liable to cause injury in case of sudden stop, collision or accident when travelling must be removed or securely fastened to a safe distance from the car seat and child.
- ❖ Do not place additional pads in the car seat than those provided by the manufacturer!
- ❖ Do not use spare parts and other components not supplied by the manufacturer! The manufacturer takes no responsibility for safety in case spare parts are used other than the original.
- ❖ Do not expose this car seat to direct sunlight to avoid injuries of the child, deformation of the car seat and especially of the plastic parts.
- ❖ The car seat does not replace a carrycot or a bed. Should your child need to sleep, then he should be placed in a suitable cot or bed.
- ❖ Strings can cause strangulation! Do not place additional strings to the product to avoid injuries or strangulation!
- ❖ Do not place the car seat on soft surface like beds or sofas! The car seat may tip over and injure or suffocate your child!
- ❖ Do not allow children play with this product!
- ❖ The packaging of the product must be kept out of the reach of children to avoid the risk of strangulation!

## MAIN FEATURES

- ❖ Suitable for babies aged 0+ months and weighing not more than 13 kg;
- ❖ Adjustable carry handle;
- ❖ Canopy;
- ❖ 3 – point Y –shaped safety harness;
- ❖ Belts adjustable in height;

**IMPORTANT!** The car seat can be installed on the frame of certain baby stroller. Compatibility between stroller and car seat is confirmed and explicitly declared by the stroller's manufacturer.

## PARTS DIAGRAM

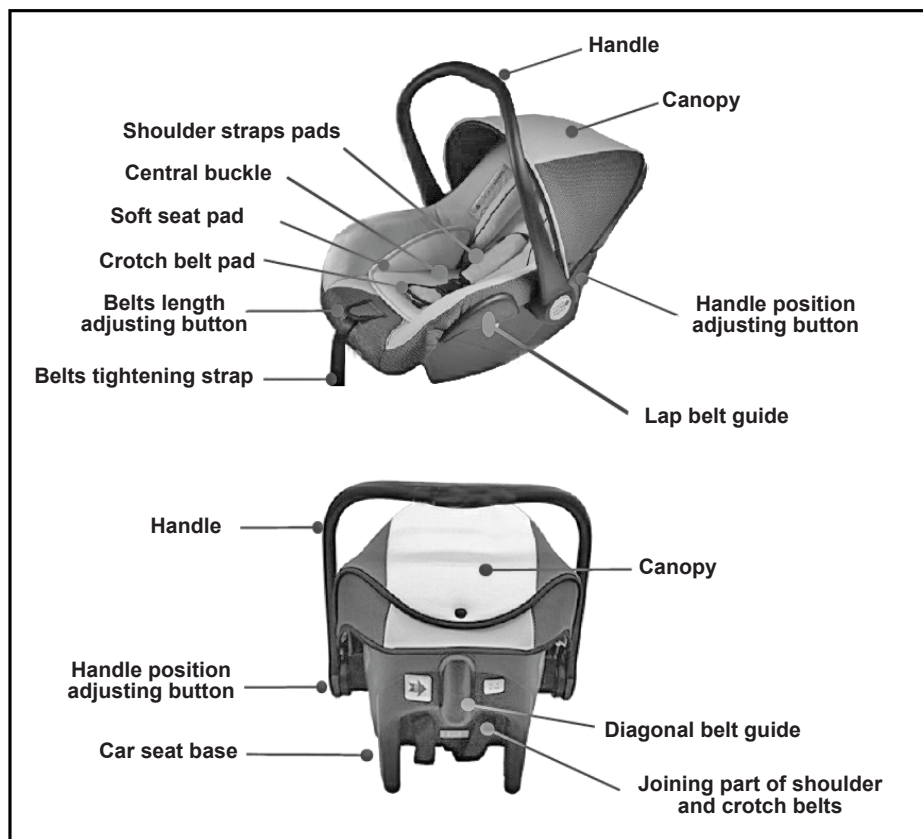

**CAUTION!** ALWAYS CHECK THE STABLE FIXING OF THE SAFETY BELTS!

## 1 – HANDLE ADJUSTMENT (3 positions)

The handle can be positioned in 3 positions. To move the handle in desired position, press the two buttons simultaneously. After fixing you must hear a click sound.

## 2 – BELT BUCKLE

Join the metal endings together and insert them into the opening of the buckle. Press until you hear a click sound, which shows that belt is locked.

**Note:** Make sure the belt is locked as try to pull the endings from the belt buckle.

To unlock the belts, press the red button in the middle.

## 3 – ADJUSTING THE HEIGHT OF THE SHOULDER BELTS (2 positions)

**IMPORTANT!** The shoulder belts must be at the child's shoulder level.

**Step 1:** Press the button for belt adjustment and loose the belts as pulling them towards you. Press the central buckle button and unfasten the harness. Remove the shoulder belts from the slots.

**Step 2:** Thread each of the shoulder belts through the desired slot.

**Step 3:** Do the same actions to adjust the second shoulder belt.

**ATTENTION!** Make sure that shoulder belts are threaded through the same height slots!

## 4 – INSTALLATION OF THE CAR SEAT INTO THE VEHICLE

Child car seat must be installed in car only in direction opposite to motion, so child is “rearwards facing”! Thread the diagonal belt of the vehicle through the diagonal belt guide. Thread the vehicle lap belt through the vehicle guides on both sides of child car seat and buckle it in the vehicle belt buckle. Tightening the 3-point car seat harness.

**CAUTION!** The vehicle belt (lap and diagonal) must be well stretched and tight after the car seat is installed! Make sure the vehicle belt and buckle are not twisted and are in correct position.

To remove the car seat, perform the same actions in reverse order.

**WARNING!** Make sure car belt and buckle are not twisted and are in correct position!

## 5 – HARNESS ADJUSTMENT

Place the child in car seat and fasten the belt, as shown in figure 2.

Adjust the belts according child's body.

### 5-1 LOOSENING THE SAFETY BELTS

**Note:** Button for loosening the belts is located under the fabric cover of car seat. Press the “PRESS” label (1).

### 5-2 – TIGHTENING THE SAFETY BELTS

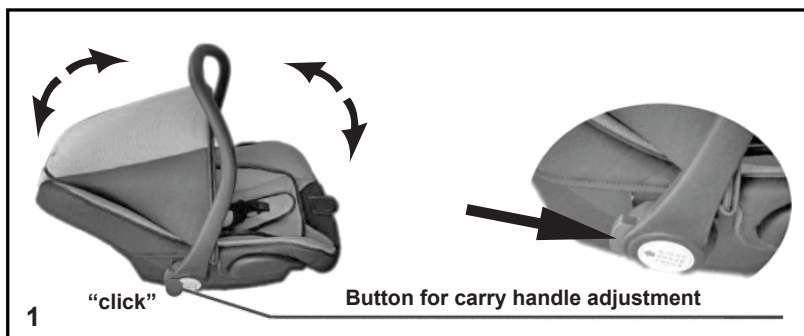

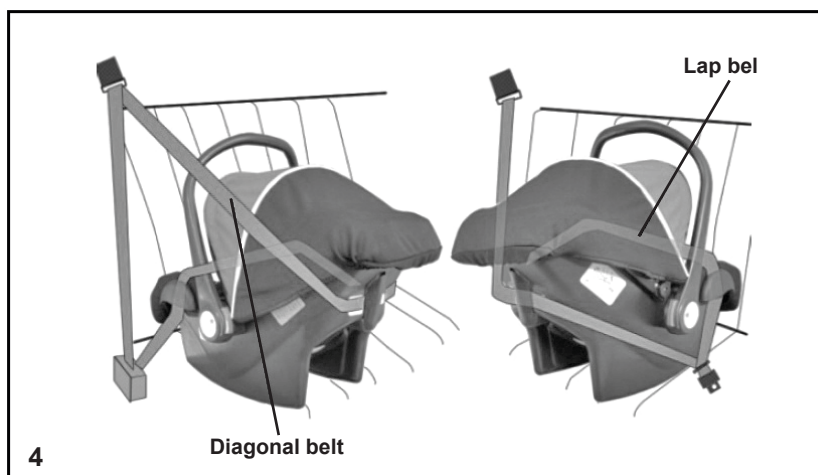
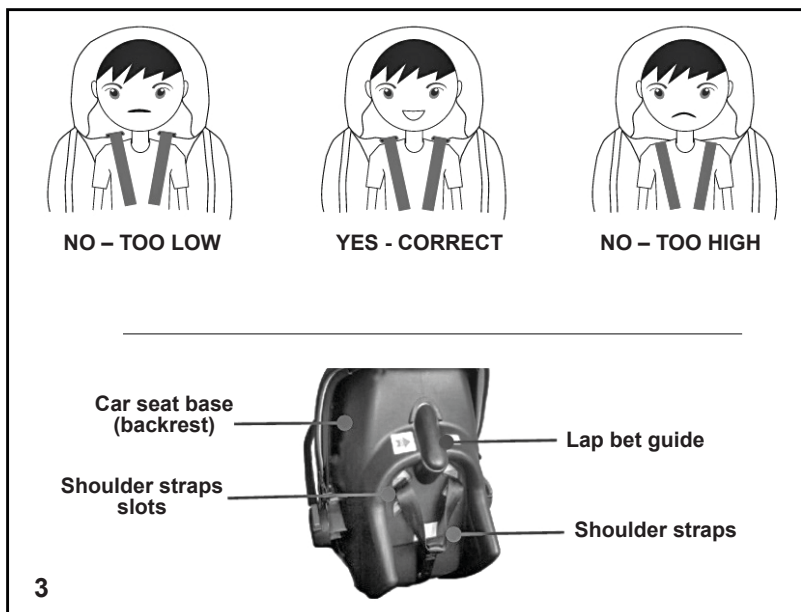
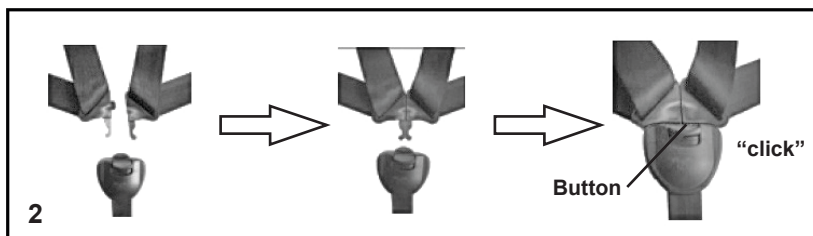



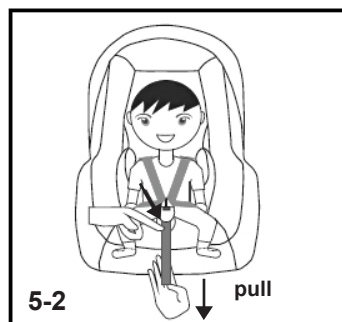
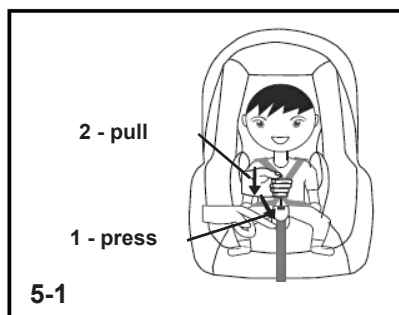

## CARE AND MAINTENANCE

- ❖ Clean the fabrics, plastic parts and metal parts with damp cotton cloth or sponge and mild soap.
- ❖ Fabric seat cover may be hand washed at 30°C!
- ❖ Do not bleach! Do not dry clean! Do not tumble dry! Do not iron!
- ❖ Do not use abrasive, bleach or other aggressive detergents.
- ❖ Always after cleaning leave the car seat fully dry and after that use it or store it. If you keep it moist, mold may appear to your car seat.
- ❖ Harnesses must be cleaned with damp cloth and mild soap!
- ❖ Do not wet or remove the stickers. They contain important information!
- ❖ Always store your car seat indoors – on dry and clean place. Do not expose to direct environment influence - sun, rain, moisture and high temperature intervals.
- ❖ Please, contact your authorized dealer for problems connected with the use or repair of this car seat.

### Fabric content:

**Shell:** 100% polyester

**Filling:** 100% polyester



**Materials used:** plastic, textile, metal

STKES021xxxx



---

1 Goliarnokonarsko shosse, Plovdiv, BULGARIA

[www.chipolino.com](http://www.chipolino.com)