

ATTENTION! READ THIS MANUAL CAREFULLY AND KEEP IT FOR FUTURE REFERENCE!

INSTRUCTION MANUAL FOR USE OF BABY TWIN STROLLER “PASSO DOBLE”

PASSO DOBLE



This stroller **chipolino** is manufactured according to the requirements of the Product Safety Directive 2001/95/EU of the European Parliament and The Council and with European standard EN 1888-1:2018 “Child care articles. Wheeled child conveyances. Part 1: Pushchairs and prams” and the regulations of national legislation.

FOLLOW ALL WARNINGS, INSTRUCTIONS AND RECOMMENDATIONS IN THIS MANUAL IN ORDER TO GUARANTEE THE SAFE USE OF THIS PRODUCT!

CAUTION! WARNINGS!

- ❖ NEVER LEAVE YOUR CHILDREN UNATTENDED!
 - ❖ FOR NEWBORN BABIES THE MOST LYING POSITION OF THE BACKRESTS IS RECOMMENDED!
 - ❖ THE SITTING POSITION OF THE RECLINING SEATS IS TO BE USED ONLY FOR A CHILDREN AT LEAST 6 MONTHS OLD!
 - ❖ KEEP AWAY FROM FIRE!
 - ❖ DO NOT LIFT THE STROLLER BY ITS FRONT BUMPER!
 - ❖ ALWAYS USE THE SAFETY BELTS ONCE THE CHILDREN CAN SIT UNAIDED!
 - ❖ MAKE SURE ALL PARKING DEVICES ARE ENGAGED BEFORE USE.
 - ❖ IN ORDER TO AVOID INJURY, MAKE SURE CHILDREN ARE AT SAFE DISTANCE FROM THE STROLLER DURING ITS ADJUSTING, UNFOLDING OR FOLDING!
 - ❖ DO NOT ALLOW YOUR CHILDREN TO PLAY WITH THE STROLLER!
 - ❖ THIS PRODUCT IS NOT SUITABLE FOR RUNNING OR SKATING!
- ❖ To be used for children weighing up to 15kg per child.
 - ❖ Adult assembly is required!
 - ❖ Do not put additional mattresses in the seats thicker than 15mm!
 - ❖ Always activate the parking device when you put the children in or out of the stroller!
 - ❖ Make sure the safety belts are correctly fastened and adjusted before each use.
 - ❖ The maximum load for the storage basket is 3 kg per basket!
 - ❖ The maximum load of the diaper bag is up to 2 kg!
 - ❖ Do not overload the stroller! Every load attached to the handle, bumper, and backrest or on the side of the stroller will affect its stability!
 - ❖ This stroller is suitable for two children.
 - ❖ Only use spare parts or other components, which are recommended or supplied by the producer! In the contrary case the producer is not responsible for the product's safety.
 - ❖ Do not make any changes or modifications to the stroller's construction! In case of problems contact the dealer or an authorized repair service for advice and/or repair.
 - ❖ Do not use this stroller if you find missing or damaged parts!
 - ❖ Do not allow children younger than 3 years near the stroller during its assembly!
 - ❖ Do not attach any strings or long cords to the stroller in order to avoid risk of suffocation!
 - ❖ Do not use the stroller on stairs or escalators and pay attention when overcoming a curb or a step.
 - ❖ Keep the plastic packaging away from children in order to avoid risk of suffocation!



1

MAIN FEATURES

- ❖ This stroller is intended for twins – two babies or little children aged from 0 up to 36 months weighing no more than 15 kg per child;
- ❖ 5-point safety harness;
- ❖ Adjustable backrests;
- ❖ Adjustable canopies;
- ❖ Adjustable leg rests;
- ❖ Straight and swivel motion of the front wheels
- ❖ Footcovers

MAIN PARTS DIAGRAM



ASSEMBLY INSTRUCTIONS AND FUNCTIONS

This stroller is supplied partially assembled. In order to complete the assembly, you don't need any tools.

IMPORTANT! Follow exactly the instructions given and check the pictures. Keep your hands from entrapment!

IMPORTANT! After each operation, make sure that you have followed the instructions correctly and the fixing is stable!

IMPORTANT! In most cases after the completion of an operation you will hear a clicking sound.

The assembly, disassembly and functions are numbered from 1 to 11. Use the operations descriptions given in this manual and their matching picture.

- 1 – Unfolding the stroller**
- 2 – Front wheels**
- 2 - 1 Front wheels installation
- 2 - 2 Front wheels removal
- 2 - 3 Straight and swivel motion of the front wheels

Note: When you move the stroller on uneven surfaces, it is recommended to fix the wheels in straight motion.

- 3 – Installation and removal of rear wheels**
- 3 - 1 Installation of rear wheels
- 3 - 2 Installation and removal of rear wheels
- (1) pull the latch
- (2) remove the wheel

- 4 – Parking device function**
- 5 – Installation and removal of safety bumper**
- 5 - 1 – Assembly of safety bumper
- 5 - 2 – Removal of safety bumper
- (1) pull the latch
- (2) remove the bumper

- 6 – Canopies**
- 6 - 1 – Installation of canopies
- 6 - 2 – Open (1) and close (2) the canopies
- CAUTION!** Always attach the canopies at the back of the seats in order to prevent the children from sliding off and injury.

- 7 – Adjusting the backrests recline positions - in 4 positions**
- Adjusting from higher to lower position – pull out the metal U-shaped tube (1) and move the backrest lower (2)
- Adjusting from lower to higher position – push the backrest with your hand up.
- Note:** When the backrest is fixed in a position you will hear a click sound.

- 8 – Leg rest**
- Adjusting from higher to lower position – press the buttons on both sides (1) and move the leg rest lower (2)
- Adjusting from lower to higher position – push the leg rest up with your hand

- 9 – Restraint system (safety belt)**
- CAUTION!** Belts must be snug to children's bodies and must not be twisted.
- IMPORTANT!** Periodically check to ensure that the seat belt is securely attached to the stroller frame as well as securely fastened. The seat belt straps must not be damaged, worn out or twisted!

3

CAUTION! Babies aged under 6 months must be put in the stroller only when seats' backrests are in most lying position! Before you place the babies in the seats, remove the shoulder safety belts or toss them to the seats' sides and cover the seats with soft pad not thicker than 15mm!

- 10 – Footcover**
- 11 – Folding the stroller**
- IMPORTANT!** Before folding the stroller, close the canopies, put the backrest in most sitting position and lower the leg rests.
- 11-1 – Press the button of the folding mechanism
- 11-2 – Rotate the handle
- 11-3 – Press the stroller down until fully folded (11-4)

Note: After the stroller is folded, fix it with the transport hook (figure 1-1)

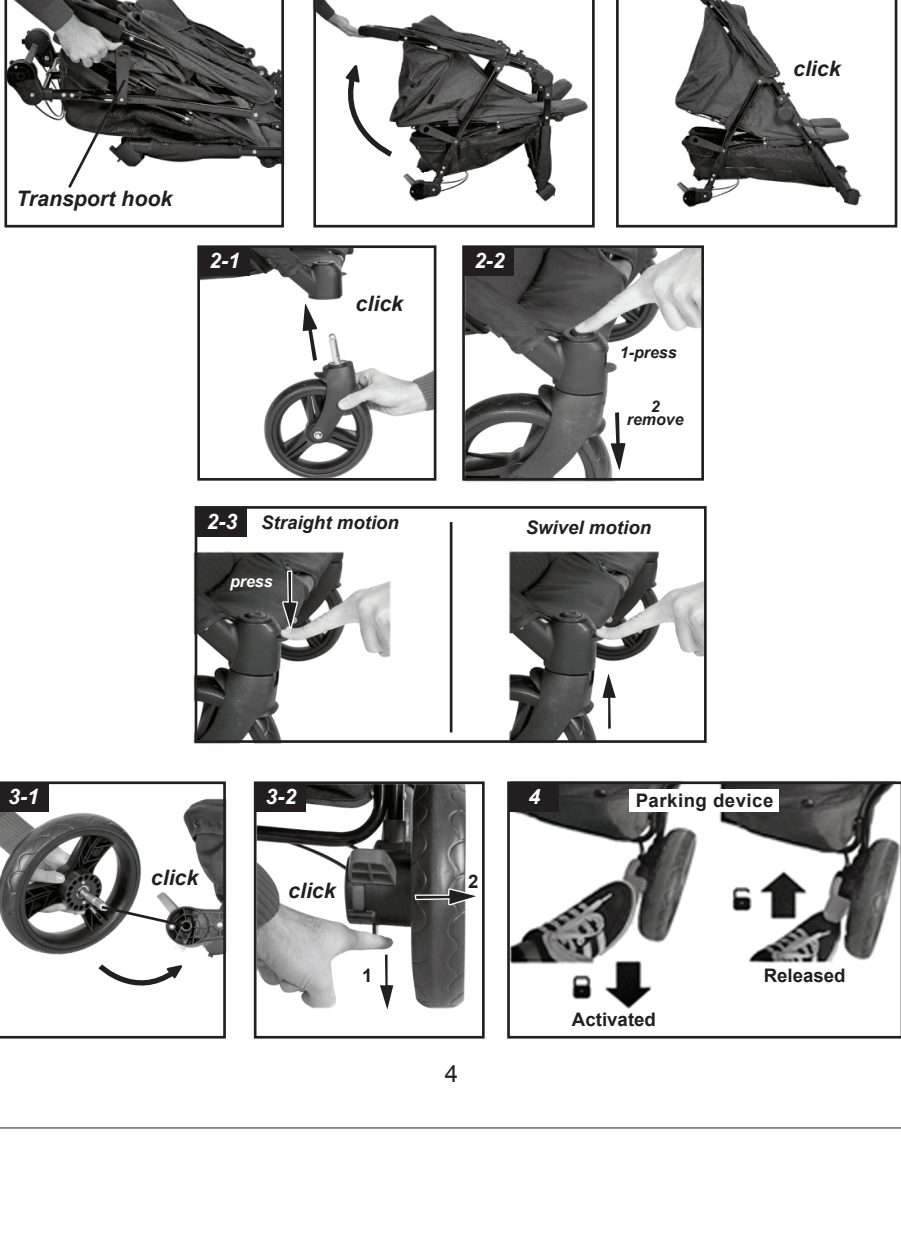

4



5

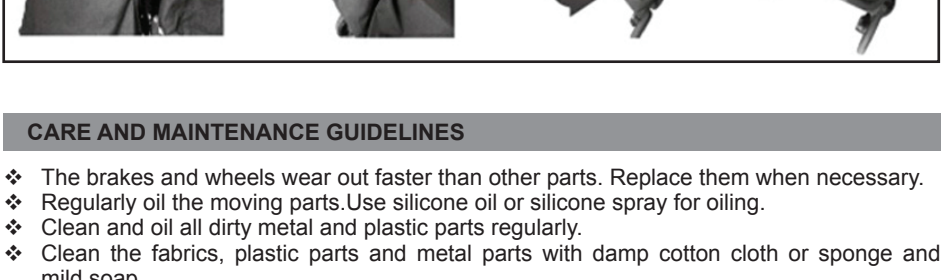

CARE AND MAINTENANCE GUIDELINES

- ❖ The brakes and wheels wear out faster than other parts. Replace them when necessary.
- ❖ Regularly oil the moving parts. Use silicone oil or silicone spray for oiling.
- ❖ Clean and oil all dirty metal and plastic parts regularly.
- ❖ Clean the fabrics, plastic parts and metal parts with damp cotton cloth or sponge and mild soap.
- ❖ Always after cleaning leave the stroller fully dry and after that use it or store it. Mold could form if you keep your stroller moist.
- ❖ Always store your stroller indoors. The effect of the environment – sea air, road covered with salt, acid rains, etc., as well as storing in the open air lead to corrosion
- ❖ Please, contact your authorized dealer for problems connected with the use or repair of this stroller.

Fabric Composition:

Outer: 100% Polyester

Filling: 100% Polyester



KBP002xxxxx

chipolino

Bulgaria, Plovdiv, str. Golyamonarsko shosse 1

www.chipolino.com