

**IMPORTANT! READ CAREFULLY KEEP THIS USER'S
MANUAL IN A SAFE PLACE FOR FUTURE REFERENCE!**

**INSTRUCTION MANUAL FOR
HIGH CHAIR AND BOOSTER SEAT
“PUDDING”**

PUDDING



This high chair **chipolino** has been manufactured in accordance with the requirements of Directive 2001/95/EC of the European Parliament and of the Council and complies with EN 14988 Children's high chairs. Safety requirements, European Standard EN 16120 Child use and care articles. Chair mounted seat and regulations of the national legislation, as well as the Consumer Protection Law.

ATTENTION! YOUR CHILD WILL BE MOST SECURE IF YOU FOLLOW THE INSTRUCTIONS AND RECOMMENDATIONS GIVEN IN THIS USER'S MANUAL!

- ❖ CAUTION! NEVER LEAVE YOUR CHILD UNATTENDED!
- ❖ CAUTION! THIS PRODUCT IS SUITABLE FOR CHILDREN, WHO CAN SIT ALONE UNAIDED (MINIMUM AGED 6 MONTHS), AGED UP TO 3 YEARS AND WEIGHING NO MORE THAN 15 KG.
- ❖ CAUTION! ALWAYS USE THE SAFETY BELTS, WHEN THE CHILD IS IN THE CHAIR! ALWAYS CHECK IF THEY ARE SECURELY FIXED TO THE HIGH CHAIR/ BOOSTER SEAT'S FRAME!
- ❖ CAUTION! DANGER OF FALLING: DO NOT LET THE CHILD CLIMB ON THE PRODUCT!
- ❖ CAUTION! ALWAYS USE THE RESTRAINT SYSTEM OF BOOSTER SEAT TO THE ADULT CHAIR AND ALWAYS CHECK IF THE HARNESSSES ARE PROPERLY FIXED AND CONNECTION IS RELIABLE AND STABLE!
- ❖ CAUTION! BEFORE USE ALWAYS CHECK SAFETY AND STABILITY OF BOOSTER CHAIR IN STALLED ON THE ADULT CHAIR!
- ❖ CAUTION! DO NOT INSTALL THE BOOSTER CHAIR ON ADULT CHAIR WITHOUT BACKREST OR ON BENCH!
- ❖ CAUTION! DO NOT USE THE HIGH CHAIR BEFORE HAVING MADE SURE THAT ALL PARTS ARE IN GOOD ORDER AND ARE SET IN THE CORRECT POSITION!
- ❖ CAUTION! KEEP THIS PRODUCT AWAY FROM FIRE! BE AWARE OF THE RISK OF OPEN FIRE AND OTHER SOURCE OF STRONG HEAT IN THE NEAR VICINITY OF THE HIGH CHAIR!
- ❖ CAUTION! OBSERVE THE RISK OF THE PRODUCT TILTING IF THE CHILD REACHES AND PUSHES WITH ITS FEET SOLD BASE SUCH AS A TABLE.
- ❖ Assembly of the product and installation of booster seat on the adult chair must be done only by adult!
- ❖ To avoid injury, make sure your child is at safe distance during folding and unfolding of the product!
- ❖ This high chair is not suitable and must not be used by children, who cannot sit unaided and stay in this position by their own (minimum 6 months of age)!
- ❖ This high chair/booster seat must not be used for children weighing more than 15 kg!
- ❖ The high chair/booster seat has a single seat, intended for one child only.
- ❖ Do not lift the product by the food tray!
- ❖ Discontinue using the product if you find any missing or damaged parts!
- ❖ Do not let your child stand in the high chair/booster seat!
- ❖ Never lift, move, make any setting or repair to the chair, while there is a child in it!
- ❖ Do not place the high chair or adult chair with installed booster seat on it on elevated and/or uneven surfaces, while there is a child in it!
- ❖ Do not place the high chair or adult chair with installed booster seat on it near stairs, swimming pools or other hazardous areas!
- ❖ Use the high chair only by its purpose!
- ❖ Do not use any spare parts or other components, which are not approved by the producer! The producer does not take any responsibility for the safety of the child when you have not used the proper and original spare parts, approved and provided by him!
- ❖ Do not apply any changes or modifications to the high chair's construction! Contact the dealer or an authorized repair service for advice and/or repair instead!
- ❖ Do not allow children younger than 3 years near the high chair during the assembly or disassembly, in order to prevent the risk of injury or swallowing of small parts!
- ❖ The packaging of the product must be kept out of the reach of children to avoid the risk of strangulation!



MAIN FEATURES

- ❖ High chair is suitable for one child, who can sit alone unaided (minimum 6 months of age)
- ❖ High chair is suitable for one child aged up to 3 years and weighing not more than 15 kg.
- ❖ High chair and small chair
- ❖ Booster seat to be installed on adult chair
- ❖ Safety harness system
- ❖ Double tray can be adjusted forth and back (3 positions) and the top tray is detachable
- ❖ Compact for storing and travel.

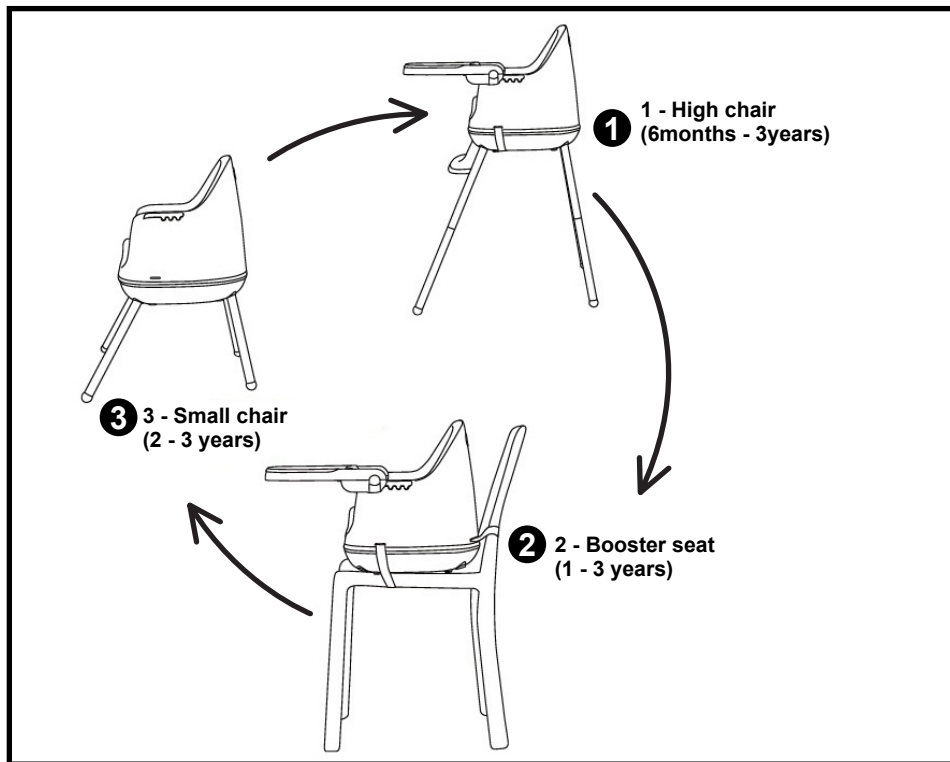

MAIN PARTS DIAGRAM

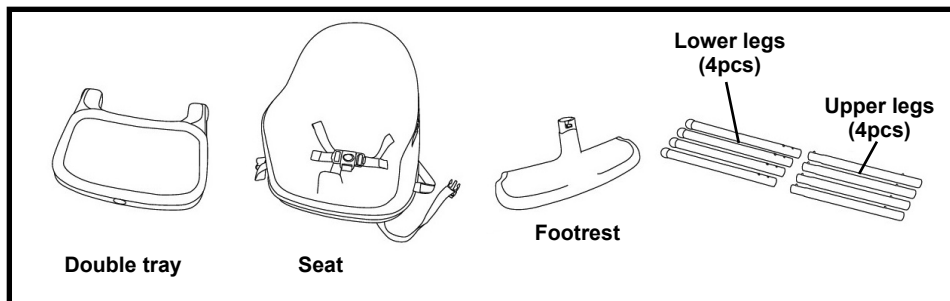

ASSEMBLY INSTRUCTIONS. FUNCTIONS

ATTENTION! Follow exactly the instructions given and the order assembly and usage, described in texts and pictures. In order to complete the assembly, you do not need any tools.

ATTENTION! CHECK THE STABILITY OF FIXING AFTER EACH OPERATION!

1. INSTALLATION OF LEGS

1-1 – Align the lower and upper legs as shown in the picture.

1-2 – Press the pin and insert the upper in the lower leg, until pin protrudes from the hole.

1-3 – Press the pin on the upper leg and insert in the seat corresponding hole, until pin is shown through the hole.

2. INSTALLATION OF FOOTREST

2-1 – Align the groove in the footrest with the seat.

2-2 – Press strongly the footrest to the seat.

2-3 – Turn it counter clockwise. The footrest is fixed.

Remark: Try to pull the footrest out in order to make sure that it is securely fixed to the seat!

3. FOOD TRAY (can be adjusted in 3 positions)

3-1 – Press the buttons on both sides of the tray and insert it in the armrests to your desired position. Release the buttons and press slightly until you hear a click and the tray is fixed.

3-2 – You can remove the top tray with your hand.

FUNCTIONS

4. ADJUSTING THE HIGH CHAIR INTO LOW CHAIR

Remove the footrest, upper and lower legs.

Install the lower legs on the seat by pressing the pins and inserting the tube in the corresponding seat opening.

Remark: The pin is shown through the hole.

Note: Save the footrest and upper legs for future use if needed.

5. BOOSTER SEAT INSTALLATION ON ADULT /REGULAR/ CHAIR

Note: Save the footrest and upper legs for future use if needed.

IMPORTANT! Place the booster seat on a chair with appropriate measurements (see the picture below)!

5-1 – Fasten the side belts under the regular chair.

5-2 – Fasten the back belts around the regular chair backrest.

5-3 – **IMPORTANT!** TIGHTEN THE BELTS (side and back belts) TO THE ADULT CHAIR, SO THAT THE BOOSTER SEAT IS SECURELY FIXED AND NOT MOVING ON THE CHAIR!

6 – SAFETY BELT

6-1 After the child is in the seat, join the buckle on the safety belt. When the belt is fixed you will hear a click.

6-2 – Tighten the safety belt.

6-3 – Loose the safety belt.

ATTENTION!

- ✓ Safety harnesses must not be worn out or torn and buckles must be strong, without any damages and provide secure connection!
- ✓ The harness must fit well the baby and must not be twisted and must not change their length when fastened!
- ✓ Do not place the baby in the booster seat if the safety harness has not been fixed first! It is important for the child's safety!

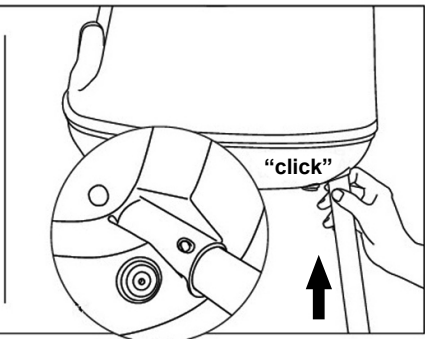
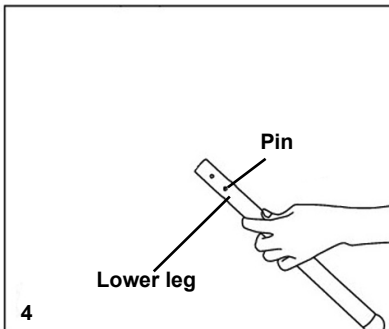
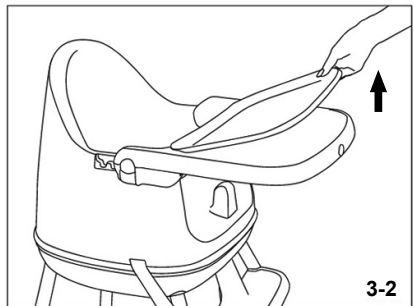
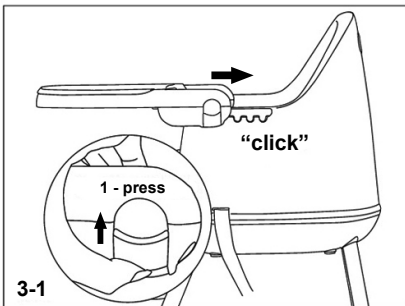
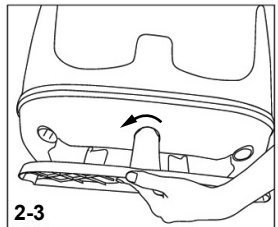
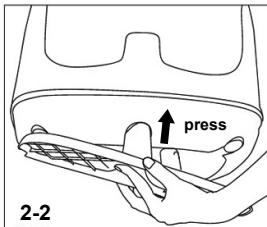
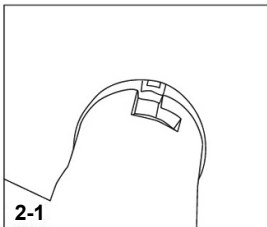
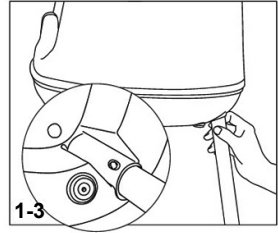
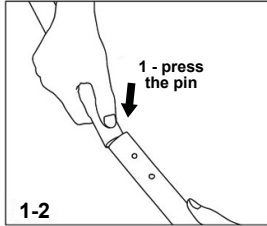
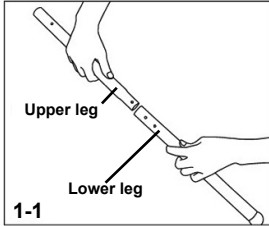

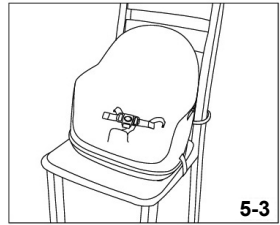
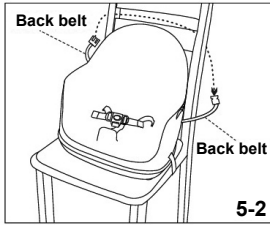
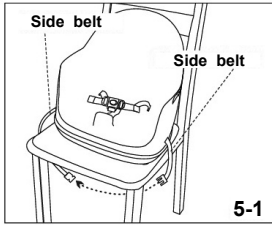

Minimum chair size

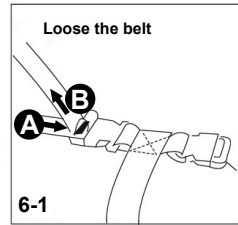
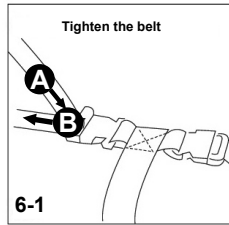
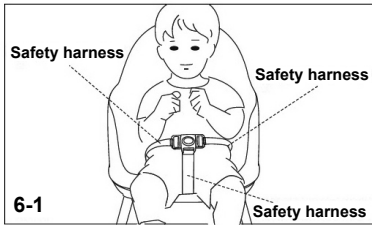
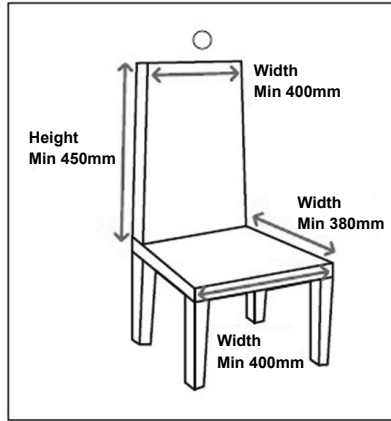

CARE AND MAINTENANCE

- ❖ Clean the plastic parts and metal parts with damp cotton cloth and mild soap.
- ❖ Do not use abrasive, bleach or other aggressive detergents.
- ❖ Always after cleaning leave the high chair to fully dry and after that use it or store it.
- ❖ Do not put any objects in the high chair or on the top of it to avoid damages of the structure.
- ❖ Always store your high chair indoors. Do not expose to direct environment influence - sun, rain, moisture and wide temperature intervals!

STHPU02xxxx



1 Goliamokonarsko shosse, Plovdiv, BULGARIA

www.chipolino.com